

PRODUKTÜBERSICHT

Typ2 [1/2"]



Mit dem Typ2 System optimieren Sie Ihren Maschinenprozess um $\pm 12\%$. Nutzen Sie die Vielfalt des Düsen Sortiments und passen Sie die Kühlung an Ihre Bedürfnisse an. Ob Flachdüsen, Runddüsen oder Düsen mit mehreren Auslässen, zum Schleifen, Drehen, Fräsen oder der Luftkühlung, finden Sie hier die passenden Elemente. Die Typ2 Grundelemente und Maschinenadapter sorgen für ein Rundes Sortiment, welches Ihnen die Sicherheit bietet, Werkzeugverschleiß zu optimieren und garantieren für eine stabile Kühlung.

TECHNISCHE DATEN:

- Größe Typ2 (1/2")
- Durchlass Ø 11,0 mm
- Druckbeständig über 100 bar
- Einsatzbereich -30°C bis +60°C
- Optional ES-System bis +300°C (auf Anfrage erhältlich)
- Gewinde (Elemente) M24x1
- Material 1.4305 (V2A)

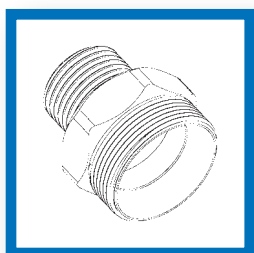
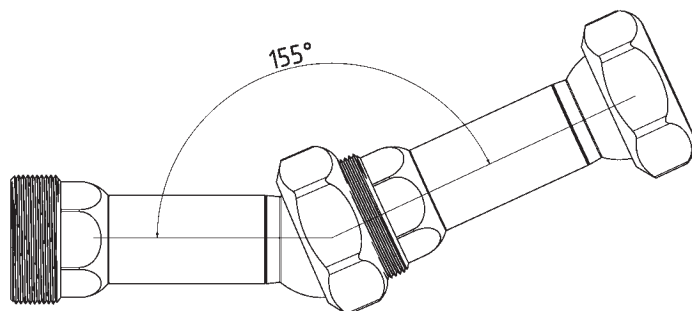
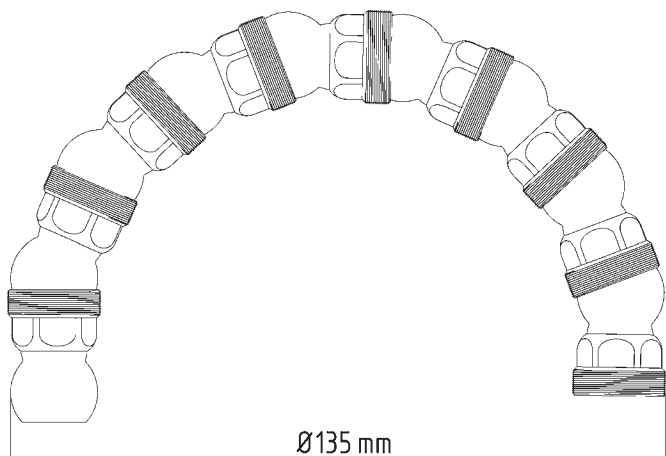

MASCHINENADAPTER

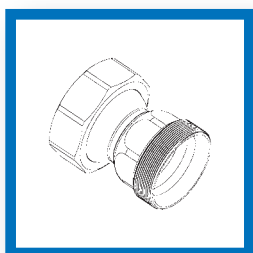

GRUNDELEMENTE

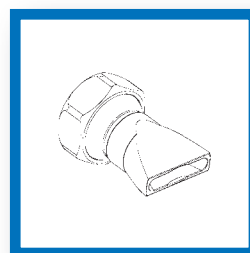

DÜSEN

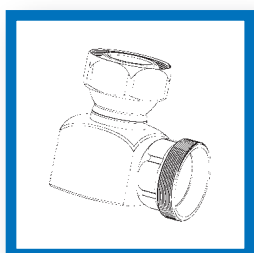

WINKELELEMENTE

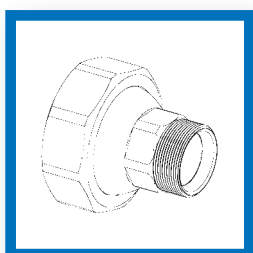

ZUBEHÖR

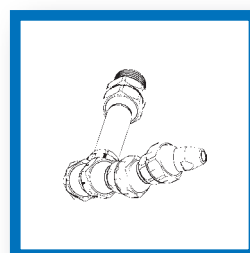

GRUNDSET Typ2

Typ2 [1/2" System]

Grundelemente | Basic Elements

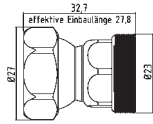
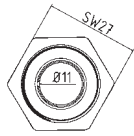

2-GE

$l = 32,7$ mm effektiv $l = 27,8$ mm
 $l = 32,7$ mm effective $l = 27,8$ mm

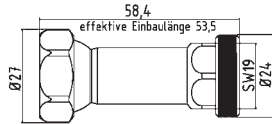
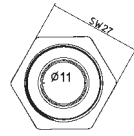

2-GE-2

$l = 58,4$ mm effektiv $l = 53,5$ mm
 $l = 58,4$ mm effective $l = 53,5$ mm

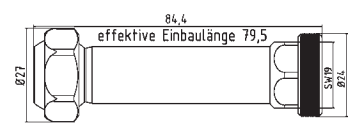
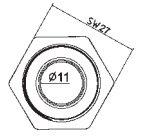

2-GE-3

$l = 84,4$ mm effektiv $l = 79,5$ mm
 $l = 84,4$ mm effective $l = 79,5$ mm

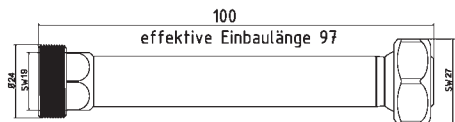
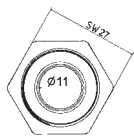

2-GE-100

$l = 100$ mm effektiv $l = 97$ mm
 $l = 100$ mm effective $l = 97$ mm

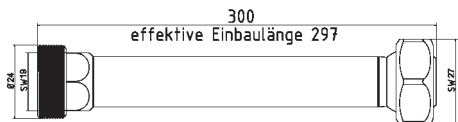
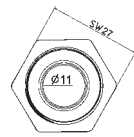

2-GE-300

$l = 300$ mm effektiv $l = 297$ mm
 $l = 300$ mm effective $l = 297$ mm

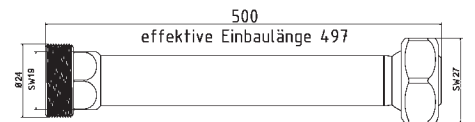
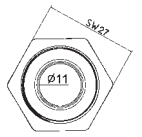

2-GE-500

$l = 500$ mm effektiv $l = 497$ mm
 $l = 500$ mm effective $l = 497$ mm

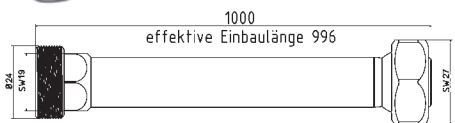
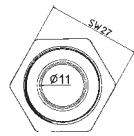

2-GE-1000

$l = 1000$ mm effektiv $l = 996$ mm
 $l = 1000$ mm effective $l = 996$ mm

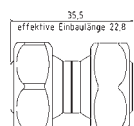
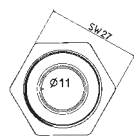

2-GE-DK

$l = 35,5$ mm effektiv $l = 22,8$ mm Doppelkugel
 $l = 35,5$ mm effective $l = 22,8$ mm double ball

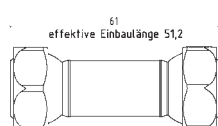
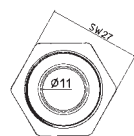

2-GE-2-DK

$l = 61$ mm effektiv $l = 51,2$ mm Doppelkugel
 $l = 61$ mm effective $l = 51,2$ mm double ball

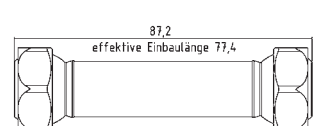
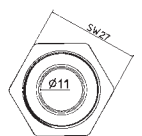

2-GE-3-DK

$l = 87,2$ mm effektiv $l = 77,4$ mm Doppelkugel
 $l = 87,2$ mm effective $l = 77,4$ mm double ball

Maschinen-/Düsenadapter | Machine-/Nozzle Adapter

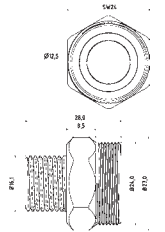
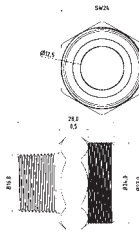
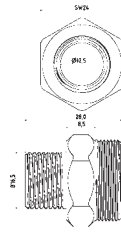

2-AD-38

Adapterstück G 3/8"
adaptor piece thread 3/8"

2-AD-38-PT

Adapterstück G 3/8" PT (Withworth-Gewinde)
adaptor piece thread 3/8" PT (NPT thread)

2-AD-38-U

Adapterstück G 3/8" U (Gewinde unterschritten)
adaptor piece thread 3/8" U (Undercut thread)

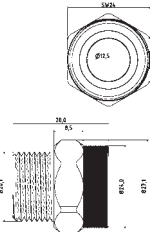
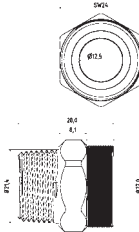
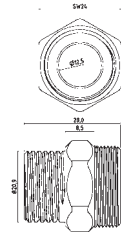

2-AD-12

Adapterstück G 1/2"
adaptor piece thread 1/2"

2-AD-12-PT

Adapterstück G 1/2" PT (Withworth-Gewinde)
adaptor piece thread 1/2" PT (NPT thread)

2-AD-12-U

Adapterstück G 1/2" U (Gewinde unterschritten)
adaptor piece thread 1/2" U (Undercut thread)

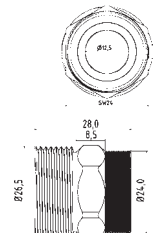
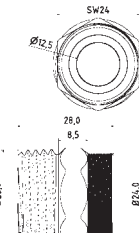
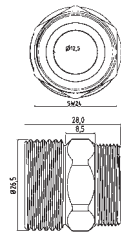

2-AD-34

Adapterstück G 3/4"
adaptor piece thread 3/4"

2-AD-34-PT

Adapterstück G 3/4" PT (Withworth-Gewinde)
adaptor piece thread 3/4" PT (NPT thread)

2-AD-34-U

Adapterstück G 3/4" U (Gewinde unterschritten)
adaptor piece thread 3/4" U (Undercut thread)

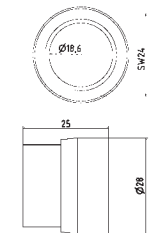
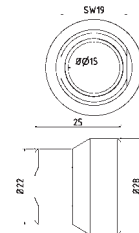
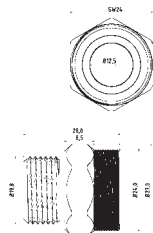

2-AD-201.5

Adapterstück M20 x 1.5"
adaptor piece thread M20 x 1.5"

2-AD-2GE-38

Adapterstück für Fremddüsen mit
Außengewinde, IG 2-GE auf IG 3/8"
adapter piece for external nozzles with
male thread, female 2-GE to female 3/8"

2-AD-2GE-12

Adapterstück für Fremddüsen mit
Außengewinde, IG 2-GE auf IG 1/2"
adapter piece for external nozzles with
male thread, female 2-GE to female 1/2"

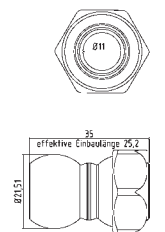
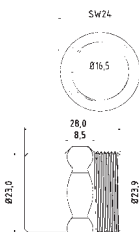
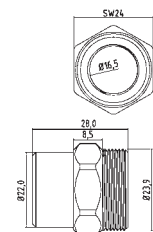

2-AD-I161.5-Typ2

Adapterstück M16 x 1.5 Innengewinde auf
Hirt-Line Typ2 Aussengewinde
adaptor piece M16 x 1.5 female thread
to Hirt-Line type2 male thread

2-AD-I181.5-Typ2

Adapterstück M18 x 1.5 Innengewinde auf
Hirt-Line Typ2 Aussengewinde
adaptor piece M18 x 1.5 female thread
to Hirt-Line type2 male thread

2-AD-LL

Adapterstück Loc-Line Typ 2
adaptor piece Loc-Line Type 2

Typ2 [1/2" System]

Winkelelemente | Elbows

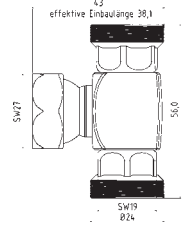
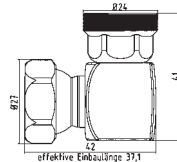
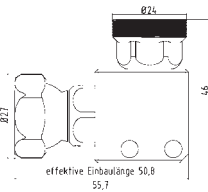
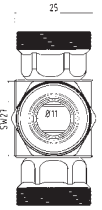
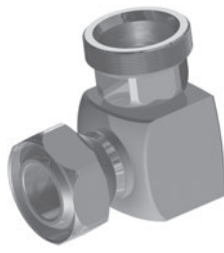
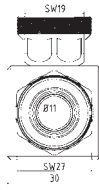
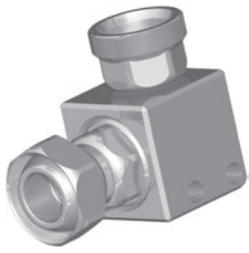

2-WI

Winkelstück für Leitungen mit 2 Bohrungen
corner piece for pipelines with 2 bore hole

2-WV-1K

Winkelstück
elbow piece

2-WV-2K

T-Stück
T-piece

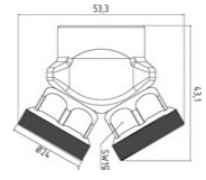
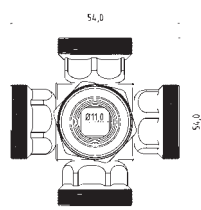
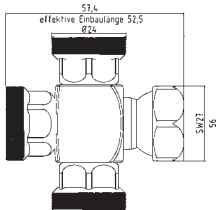
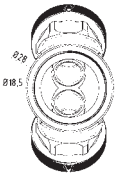
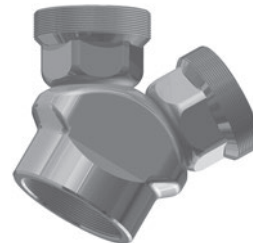
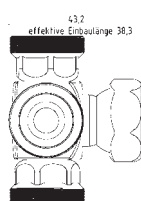
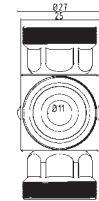
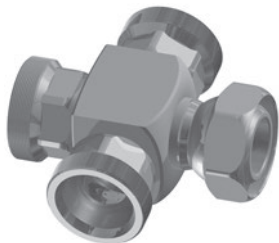

2-WV-3K

Kreuz-Stück
cross piece

2-WV-4K

Stern-Stück
star piece

2-YV

Y-Stück 50°
Y-piece 50°

Düsen | Nozzles

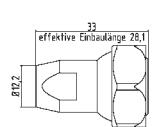
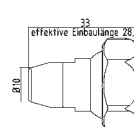
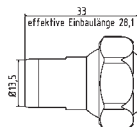
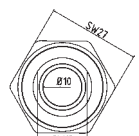
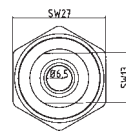
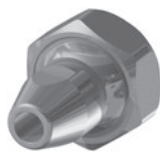
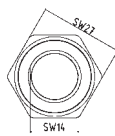
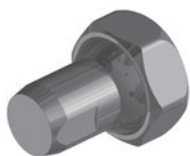

2-DU-0

Düse ohne Bohrung (für Spezialanwendungen)
nozzle without hole (for special applications)

2-DU-65

Düse gerade Bohrung \varnothing 6,5 mm
nozzle straight \varnothing 6,5 mm

2-DU-10

Düse gerade Bohrung \varnothing 10 mm
nozzle straight \varnothing 10 mm

Düsen | Nozzles

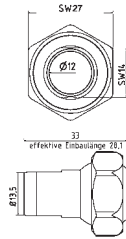

2-DU-12

Düse gerade Bohrung Ø 12 mm
nozzle straight Ø 12 mm

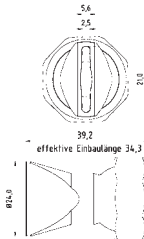

2-DU-SL-25-SS

Flachdüse Schlitzbreite 20 x 2,5 mm
Streustrahl
flat nozzle broadly with slit 20 x 2,5 mm
scattered beam

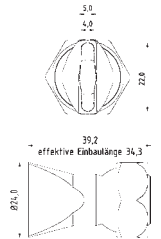

2-DU-SL-25

Flachdüse Schlitzbreite 22 x 4,0 mm
Streustrahl
flat nozzle broadly with slit 22 x 4,0 mm
scattered beam

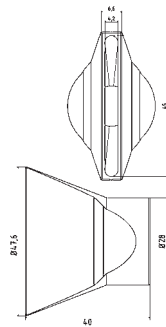
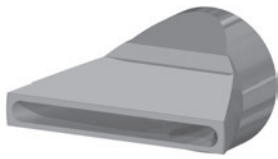

2-DU-SL-50

Flachdüse Schlitzbreite 45 x 4,2 mm
Streustrahl
flat nozzle broadly with slit 45 x 4,2 mm
scattered beam

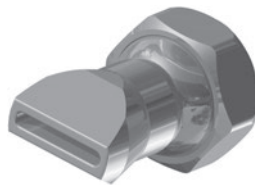

2-DU-SL-25-GS

Flachdüse Schlitzbreite 18 x 2,5 mm
gerader Strahl
flat nozzle broadly with slit 18 x 2,5 mm
straight jet

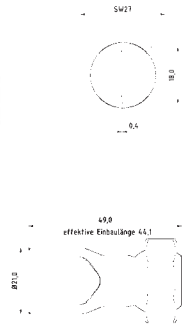
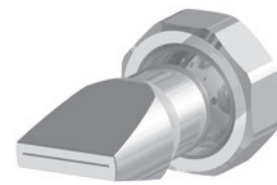

2-DU-SL-25-GS-0.4

Flachdüse Schlitzbreite 18 x 0,4 mm
gerader Strahl
flat nozzle broadly with slit 18 x 0,4 mm
straight jet

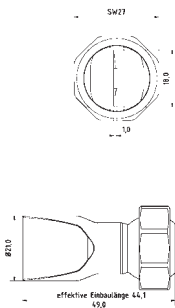

2-DU-SL-25-GS-1.0

Flachdüse Schlitzbreite 18 x 1,0 mm
gerader Strahl
flat nozzle broadly with slit 18 x 1,0 mm
straight jet

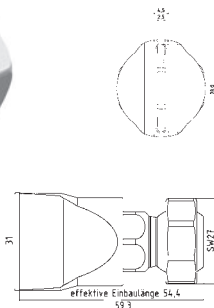
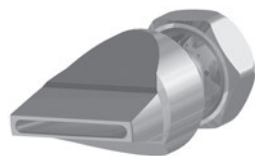

2-DU-SL-31-GS

Flachdüse Schlitzbreite 28 x 2,5 mm
gerader Strahl
flat nozzle broadly with slit 28 x 2,5 mm
straight jet

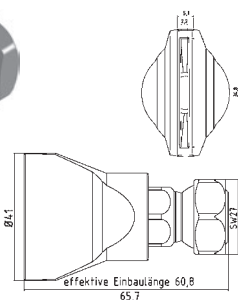
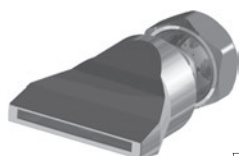

2-DU-SL-50-GS

Flachdüse Schlitzbreite 35 x 2,2 mm
gerader Strahl
flat nozzle broadly with slit 35 x 2,2 mm
straight jet

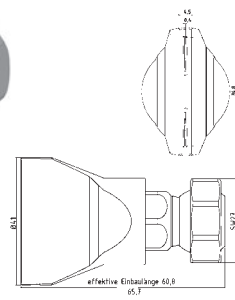
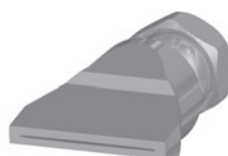

2-DU-SL-50-GS-0.4

Flachdüse Schlitzbreite 35 x 0,4 mm
gerader Strahl
flat nozzle broadly with slit 35 x 0,4 mm
straight jet

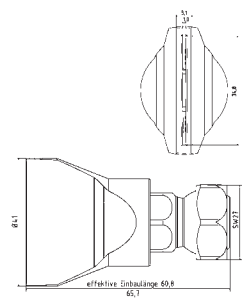
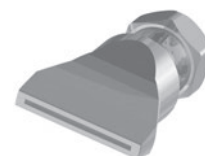

2-DU-SL-50-GS-1.0

Flachdüse Schlitzbreite 35 x 1,0 mm
gerader Strahl
flat nozzle broadly with slit 35 x 1,0 mm
straight jet

Typ2 [1/2" System]

Düsen | Nozzles

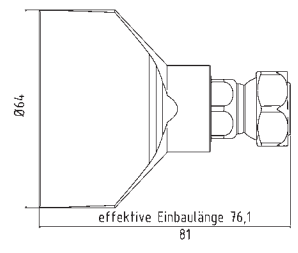
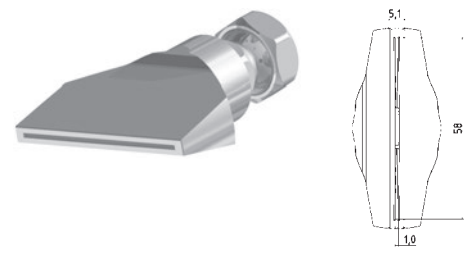
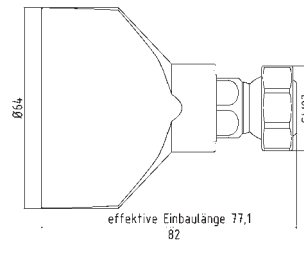
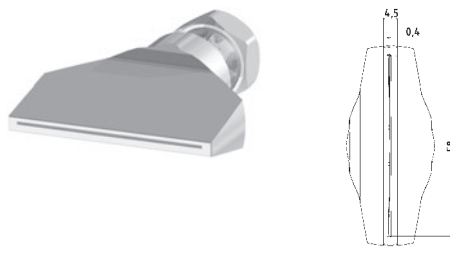
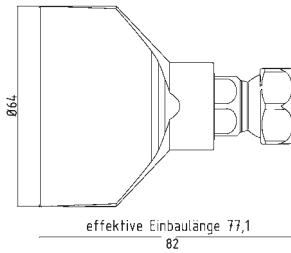
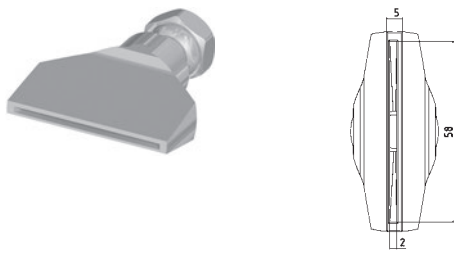

2-DU-SL-65-GS

Flachdüse Schlitzbreite 58 x 2,0 mm
gerader Strahl
*flat nozzle broadly with slit 58 x 2,0 mm
straight jet*

2-DU-SL-65-GS-0.4

Flachdüse Schlitzbreite 58 x 0,4 mm
gerader Strahl
*flat nozzle broadly with slit 58 x 0,4 mm
straight jet*

2-DU-SL-65-GS-1.0

Flachdüse Schlitzbreite 58 x 1,0 mm
gerader Strahl
*flat nozzle broadly with slit 58 x 1,0 mm
straight jet*

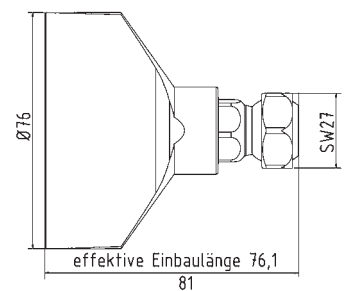
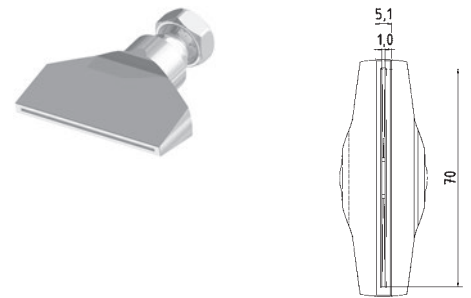
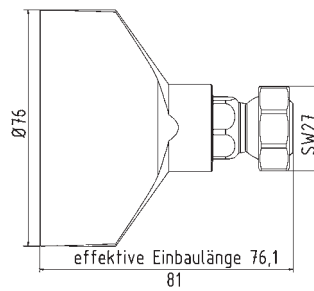
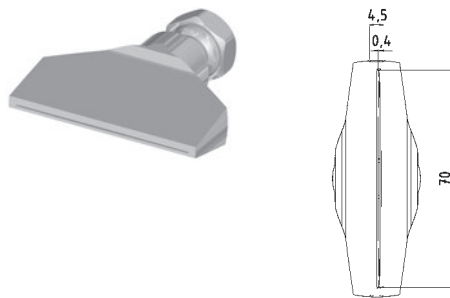
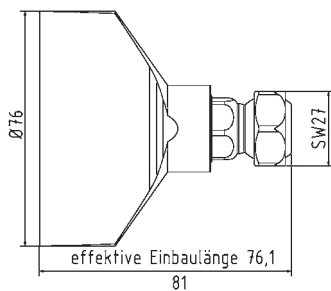
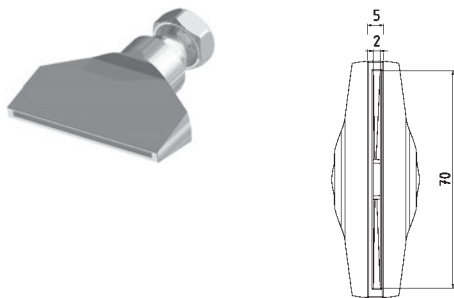

2-DU-SL-76-GS

Flachdüse Schlitzbreite 70 x 2,0 mm
gerader Strahl
*flat nozzle broadly with slit 70 x 2,0 mm
straight jet*

2-DU-SL-76-GS-0.4

Flachdüse Schlitzbreite 70 x 0,4 mm
gerader Strahl
*flat nozzle broadly with slit 70 x 0,4 mm
straight jet*

2-DU-SL-76-GS-1.0

Flachdüse Schlitzbreite 70 x 1,0 mm
gerader Strahl
*flat nozzle broadly with slit 70 x 1,0 mm
straight jet*

Düsen | Nozzles

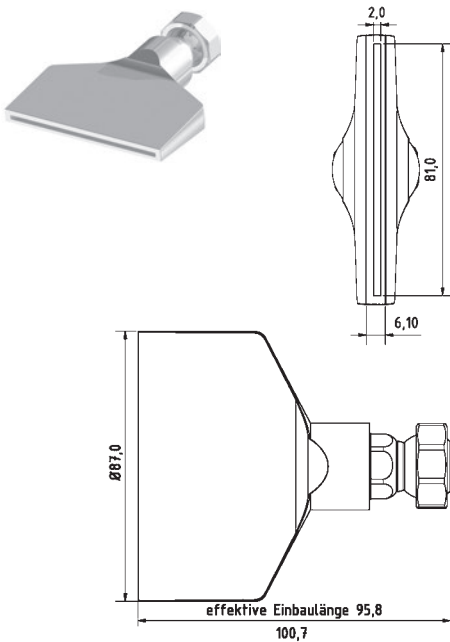

2-DU-SL-87-GS

Flachdüse Schlitzbreite 81 x 2,0 mm
gerader Strahl
*flat nozzle broadly with slit 81 x 2,0 mm
straight jet*

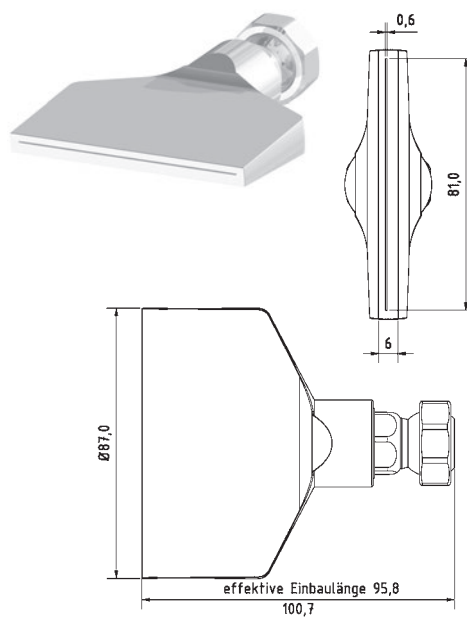

2-DU-SL-87-GS-0.6

Flachdüse Schlitzbreite 81 x 0,6 mm
gerader Strahl
*flat nozzle broadly with slit 81 x 0,6 mm
straight jet*

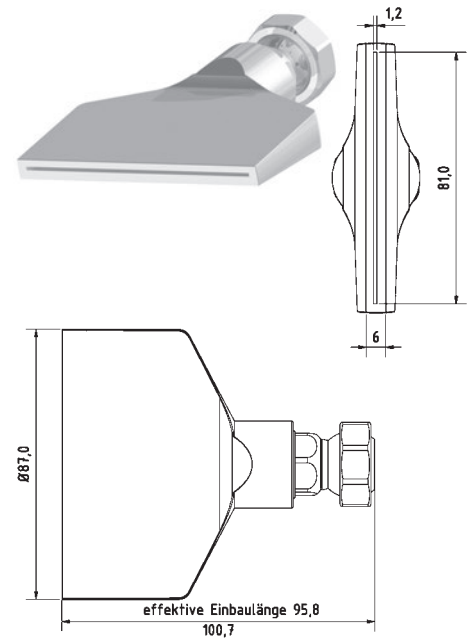

2-DU-SL-87-GS-1.2

Flachdüse Schlitzbreite 81 x 1,2 mm
gerader Strahl
*flat nozzle broadly with slit 81 x 1,2 mm
straight jet*

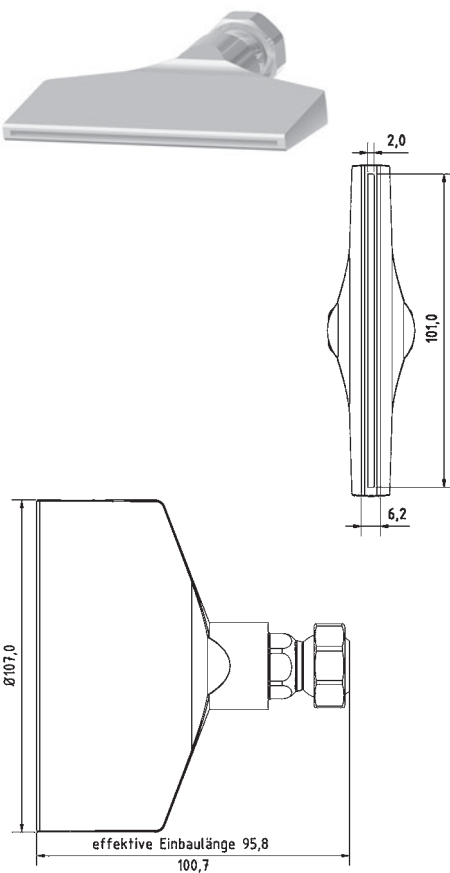

2-DU-SL-107-GS

Flachdüse Schlitzbreite 101 x 2,0 mm
gerader Strahl
*flat nozzle broadly with slit 101 x 2,0 mm
straight jet*

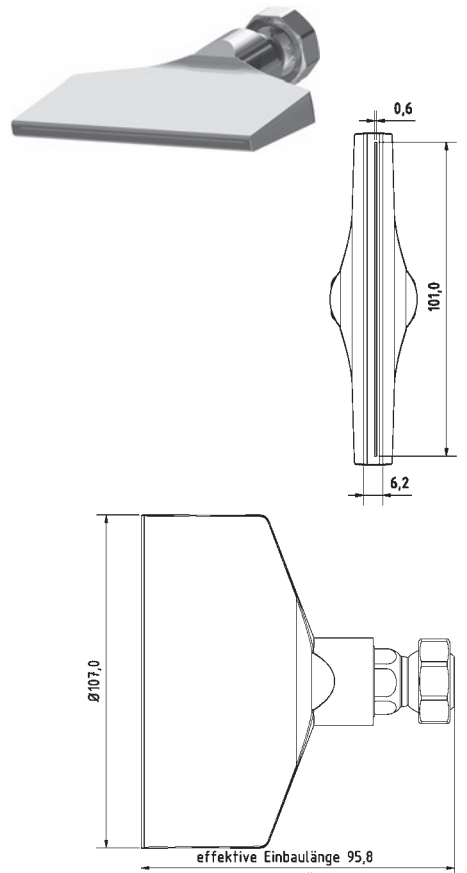

2-DU-SL-107-GS-0.6

Flachdüse Schlitzbreite 101 x 0,6 mm
gerader Strahl
*flat nozzle broadly with slit 101 x 0,6 mm
straight jet*

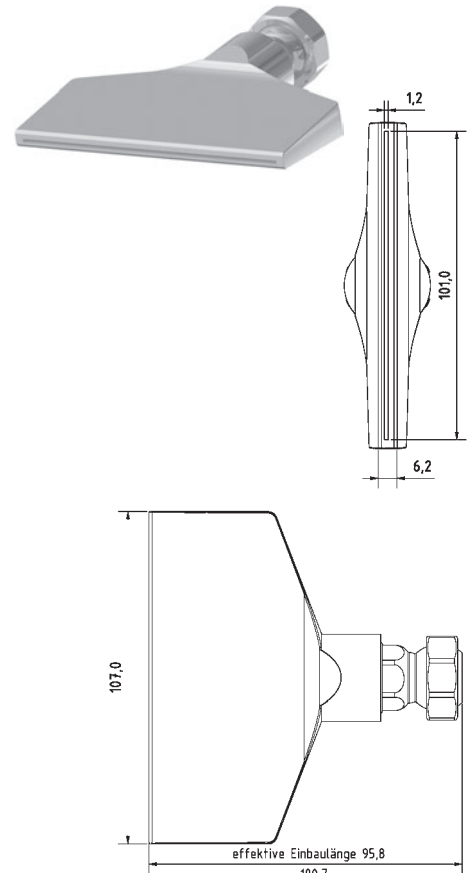

2-DU-SL-107-GS-1.2

Flachdüse Schlitzbreite 101 x 1,2 mm
gerader Strahl
*flat nozzle broadly with slit 101 x 1,2 mm
straight jet*

Typ2 [1/2" System]

Düsen | Nozzles

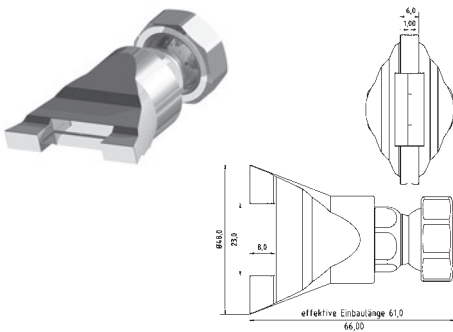

2-DU-1912-SA

Flachdüse Schlitzbreite 23 mm mit seitlicher Kühlung gerader Strahl

flat nozzle broadly with slit 23 mm with lateral cooling straight jet

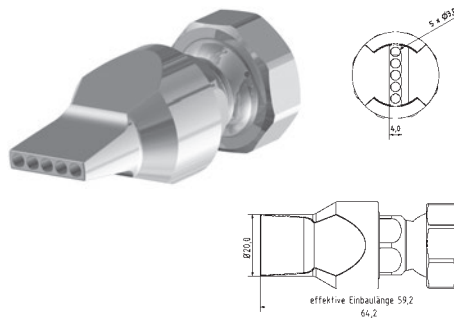

2-DU-LL-5-3

Düse gerade Bohrungen 5 x Ø 3 mm
nozzle straight drill holes 5 x Ø 3 mm

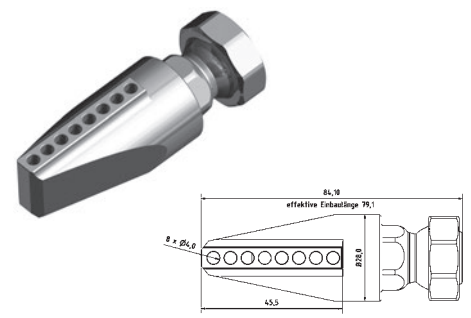

2-DU-LL-90-8

Düse 90° Bohrungen 8 x Ø 4 mm
nozzle 90° drill holes 8 x Ø 4 mm

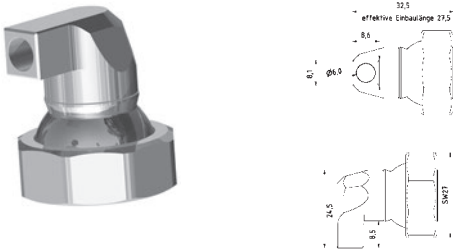

2-DU-LL-90-1-6

Düse 90° Bohrung 1 x Ø 6 mm
nozzle 90° drill hole 1 x Ø 6 mm

Kunststoff-Düsen | Plastic Nozzles



KU-2-DU-65

Kunststoff-Düse gerade Bohrung Ø 6,5 mm
plastic nozzle straight Ø 6,5 mm

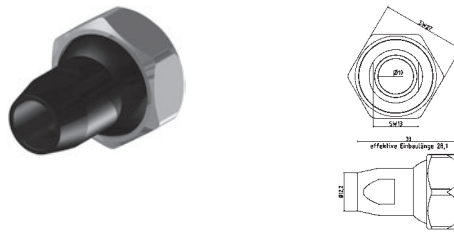

KU-2-DU-10

Kunststoff-Düse gerade Bohrung Ø 10 mm
plastic nozzle straight Ø 10 mm



KU-2-DU-12

Kunststoff-Düse gerade Bohrung Ø 12 mm
plastic nozzle straight Ø 12 mm

Zubehör | Accessories

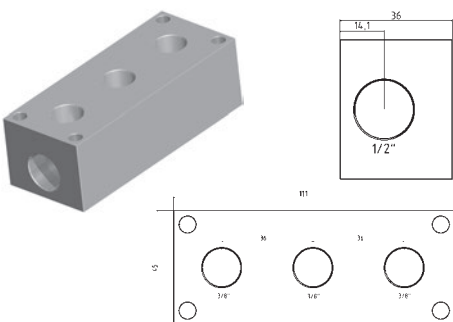

VB-3-38

Verteilerblock Eingang Stirnseite G1/2"
manifold block entrance front end 1/2"

VB-3-38-PT

Verteilerblock Eingang Stirnseite G1/2" PT
manifold block entrance front end 1/2" NPT



VB-3-38-BS

Blindstopfen G3/8"
blank plug with thread 3/8"

VB-3-38-PT-BS

Blindstopfen mit G3/8" PT Gewinde
blank plug with thread 3/8" NPT

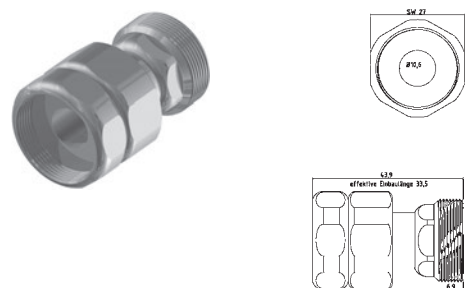

2-FP

Zwischenelement mit fester Position
(Schnellkupplung)
Intermediate element with fixed position
(quick coupling)

Zubehör | Accessories

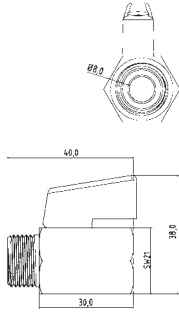

KH-38

Mini-Kugelhahn G3/8" Messing Verchromt
mini ball valve thread 3/8" brass chrome-plated

KH-38-SS

Mini-Kugelhahn G3/8" Edelstahl
mini ball valve thread 3/8" stainless steel

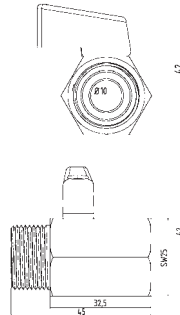

KH-12

Mini-Kugelhahn G1/2" Messing Verchromt
mini ball valve thread 1/2" brass chrome-plated

KH-12-SS

Mini-Kugelhahn G1/2" Edelstahl
mini ball valve thread 1/2" stainless steel

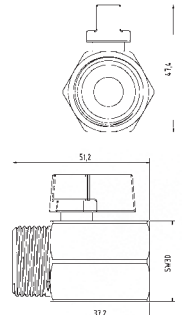

KH-34

Mini-Kugelhahn G3/4" Messing Verchromt
mini ball valve thread 3/4"

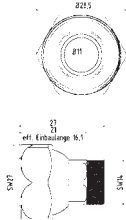

RE-2-1

Reduktion Typ 2 auf Typ 1
reduction Type 2 to Type 1

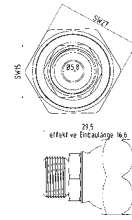

RE-2-G1/4

Reduktion Typ 2 auf G 1/4"
reduction Type 2 to G 1/4"

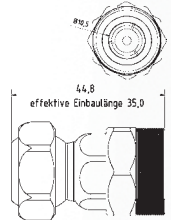

2-RSV

Rückschlagventil (Drop-Stop)
Check valve (Drop-Stop)

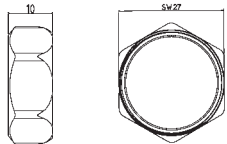

2-MU

Mutter Standard
screw nut (default)

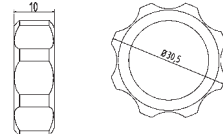
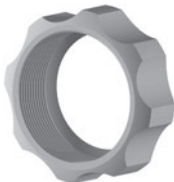

2-MU-HA

Mutter für Handverstellung
screw nut (hand feed)

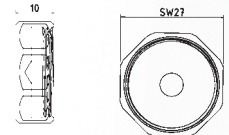
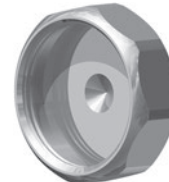

2-VK

Verschlusskappe Typ 2
cap type 2



SW-19

Schlüssel aus Stahl SW19
open end wrench SW19



SW-27

Schlüssel aus Stahl SW27
open end wrench SW27

Grundset | Basic Set

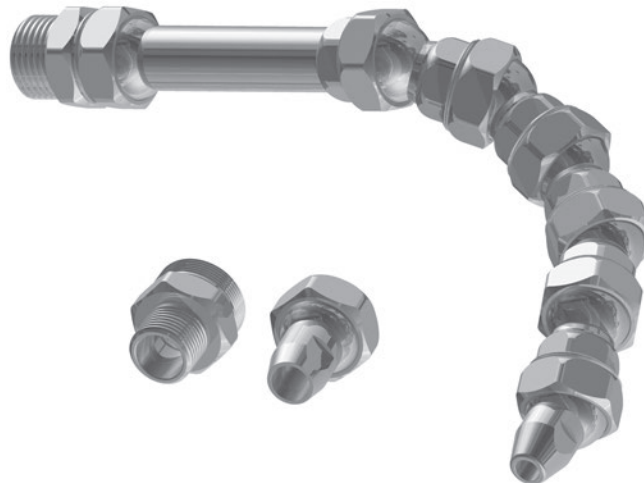

2-GS

Grundset Typ2 1/2" System L = 240 mm
basic set Type2 1/2" system l = 240 mm
5 x 2-GE, 1 x 2-GE-3, 1 x 2-AD-38, 1 x 2-AD-12, 1 x 2-DU-65 1 x 2-DU-10, 1 x SW-19, 1 x SW-27
5 x 2-GE, 1 x 2-GE-3, 1 x 2-AD-38, 1 x 2-AD-12, 1 x 2-DU-65 1 x 2-DU-10, 1 x SW-19, 1 x SW-27